

Appendix A: Proposed Duke Street Design Concept

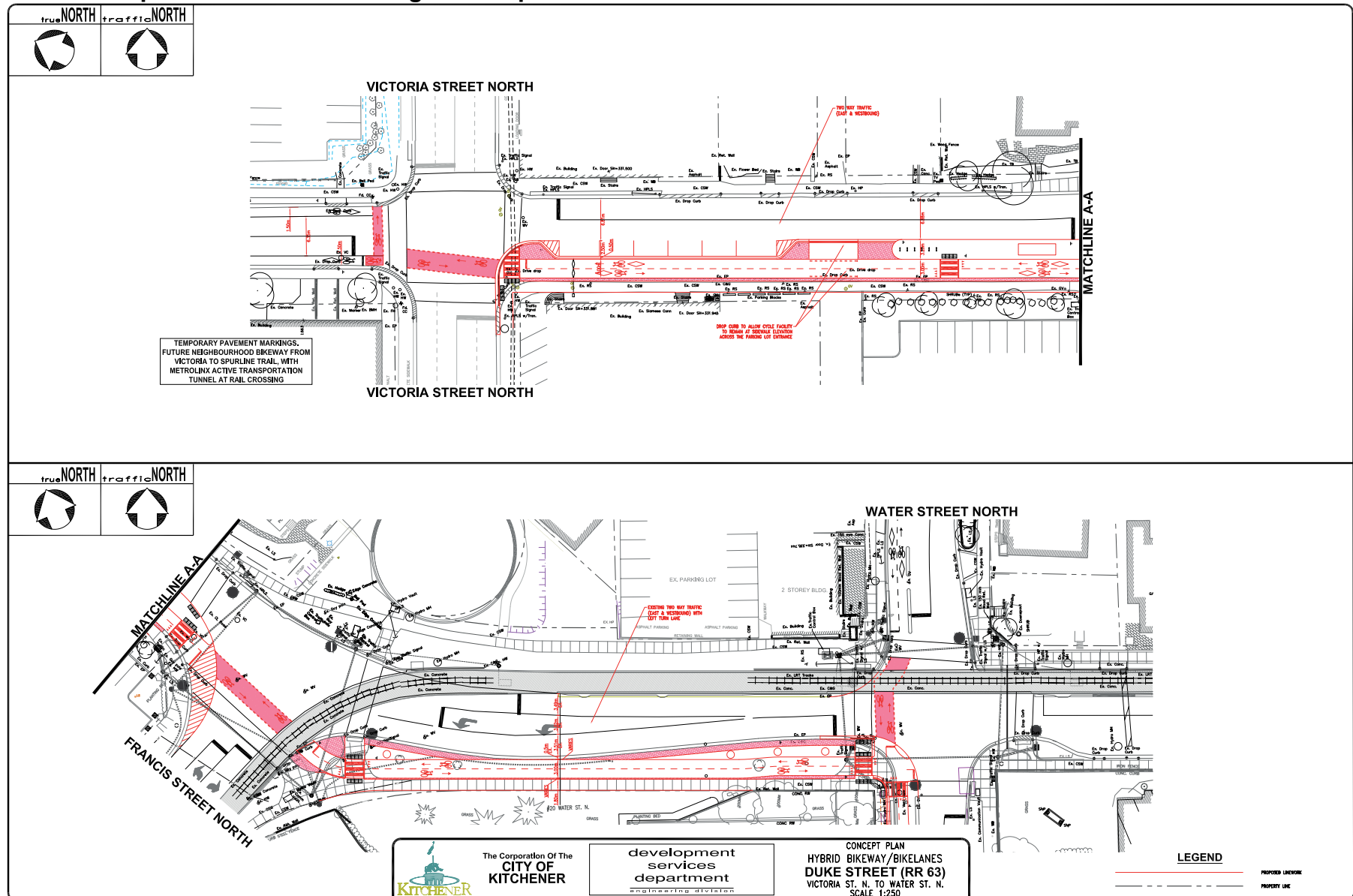

Appendix A is a technical drawing showing the positioning of the cycling facility along Duke Street between Water Street and Victoria Street. The cycling facility is two directional, it is on the west side of the street between the sidewalk and the vehicular lane. It is located in the boulevard space and it is separated from the sidewalk with pavers or stamped concrete. At the intersections with Francis and Victoria there are cross rides which is a dedicated space for cyclists to cross beside the sidewalk. The design concept keeps pedestrians and cyclists separated to minimize conflicts. At locations where the pedestrian's and cyclist's path cross, there is signage to provide priority to pedestrians.